

2107 RURAL (RL) DISTRICT

2107.A PURPOSE

The Rural District includes rural land that is accessible from maintained roads. Farm and forest lands predominate with low densities of residential development and businesses. It is the intent of this district to: (1) Protect the town’s rural character and environmental quality through low-impact approaches to development; (2) Accommodate rural residential development on those lands that are capable of supporting it; and (3) Allow for tourism, recreation and resource based uses that generate income for rural landowners while maintaining farm and forest land.

2107.B DIMENSIONAL STANDARDS

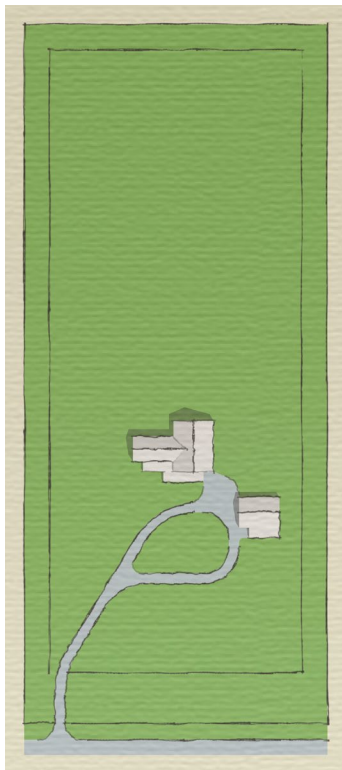

LOTS		
(1)	Minimum lot size	3 acres
(2)	Minimum lot frontage	240 feet
(3)	Maximum lot coverage	10 percent

SETBACKS		
(4)	Minimum front setback	40 feet
(5)	Maximum front setback	n/a
(6)	Minimum side and rear setbacks	20 feet
(7)	Minimum stream or shoreline setbacks	50 feet

STRUCTURES		
(8)	Maximum principal building footprint	n/a
(9)	Minimum principal building height	n/a
(10)	Maximum structure height	36 feet

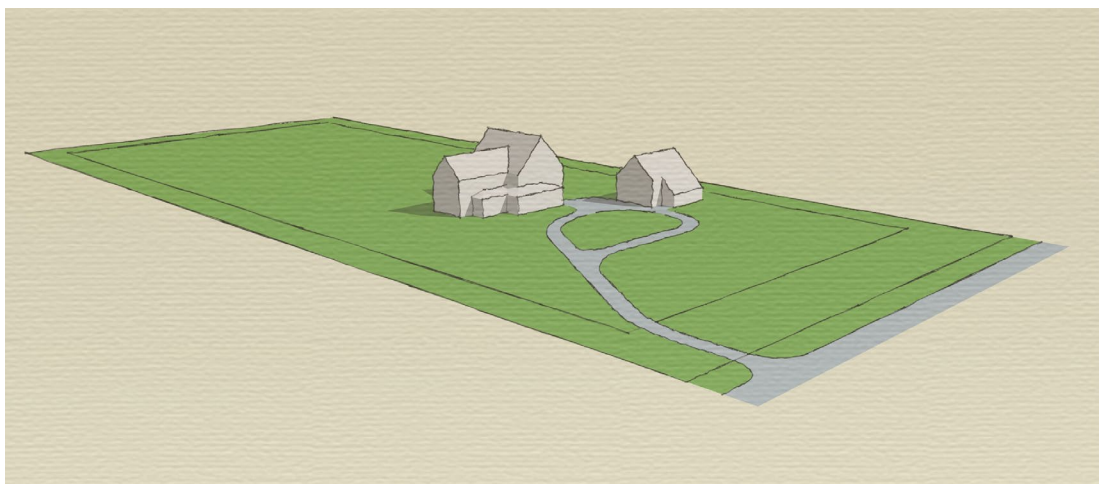

2107.C PERMITTED USES

- | | | |
|---|---|---|
| <p>Residential and Lodging Uses</p> <ul style="list-style-type: none"> (1) Single-family dwelling (2) Two-family dwelling (3) Multi-family dwelling ^{SP} (4) Rooming & boarding house ^{SP} (5) Accessory dwelling (6) Primitive camp (7) Home occupation (8) Family childcare home (9) Bed and breakfast (10) Short-term rental (11) Group home | <p>Art and Entertainment Uses</p> <ul style="list-style-type: none"> (12) Public outdoor recreation, park or nature preserve ^{SP} <p>Civic and Community Uses</p> <ul style="list-style-type: none"> (13) Cemetery ^{SP} | <p>Natural Resource Based Uses</p> <ul style="list-style-type: none"> (14) Farming or forestry (15) On-farm business ^{SP} |
|---|---|---|

Notes
^{SP} Site plan review required

2107.D CONDITIONAL USES

- | | | |
|--|---|---|
| <p>Residential and Lodging Uses</p> <ul style="list-style-type: none"> (1) Home business ^{SP} (2) Care home ^{SP} (3) Lodging facility ^{SP} (4) Campground or resort ^{SP} <p>Commercial Uses</p> <ul style="list-style-type: none"> (5) Lawn, garden or farm supply sales ^{SP} (6) Lumberyard and building supply sales ^{SP} (7) Veterinary, pet or animal service ^{SP} (8) Event facility ^{SP} | <p>Industrial Uses</p> <ul style="list-style-type: none"> (9) Food and beverage products manufacturing ^{SP} (10) Wood products manufacturing ^{SP} (11) Stone products manufacturing ^{SP} (12) Storage and distribution services ^{SP} (13) Media recording or broadcasting studio ^{SP} (14) Communications antenna ^{SP} (15) Communications tower ^{SP} (16) Waste services ^{SP} (17) Contractor's yard or unenclosed storage ^{SP} | <p>Art and Entertainment Uses</p> <ul style="list-style-type: none"> (18) Artist gallery or studio ^{SP} (19) Museum or library ^{SP} (20) Commercial outdoor recreation ^{SP} (21) Golf course or country club ^{SP} (22) Equestrian facility ^{SP} <p>Civic and Community Uses</p> <ul style="list-style-type: none"> (23) Government facility ^{SP} (24) Educational institution ^{SP} (25) Specialty school ^{SP} (26) Clinic or outpatient care services ^{SP} (27) Child day care ^{SP} (28) Religious institution ^{SP} (29) Social club ^{SP} <p>Natural Resource Based Uses</p> <ul style="list-style-type: none"> (30) Firewood processing ^{SP} (31) Extraction and quarrying ^{SP} (32) Agricultural enterprise ^{SP} |
|--|---|---|

Notes
^{SP} Site plan review required