

2103 VILLAGE RESIDENTIAL (VR) DISTRICT

2103.A PURPOSE

The Village Residential District encompasses lands in and near the Londonderry and South Londonderry village centers. These areas include both established residential neighborhoods and land suitable for future residential development. It is the intent of this district to: (1) Maintain and extend the built pattern of compact, pedestrian-friendly residential neighborhoods; (2) Allow for residential uses and compatible non-residential uses; and (3) Allow for a diversity of housing types and densities.

2103.B DIMENSIONAL STANDARDS

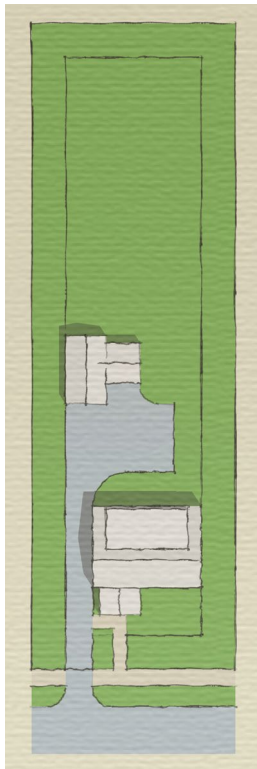

LOTS		
(1)	Minimum lot size	¼ acre
(2)	Minimum lot frontage	60 feet
(3)	Maximum lot coverage	40 percent

SETBACKS		
(4)	Minimum front setback	10 feet
(5)	Maximum front setback	n/a
(6)	Minimum side and rear setbacks	10 feet
(7)	Minimum stream or shoreline setbacks	25 feet

STRUCTURES		
(8)	Maximum principal building footprint	6,000 sq feet
(9)	Minimum principal building height	n/a
(10)	Maximum structure height	36 feet

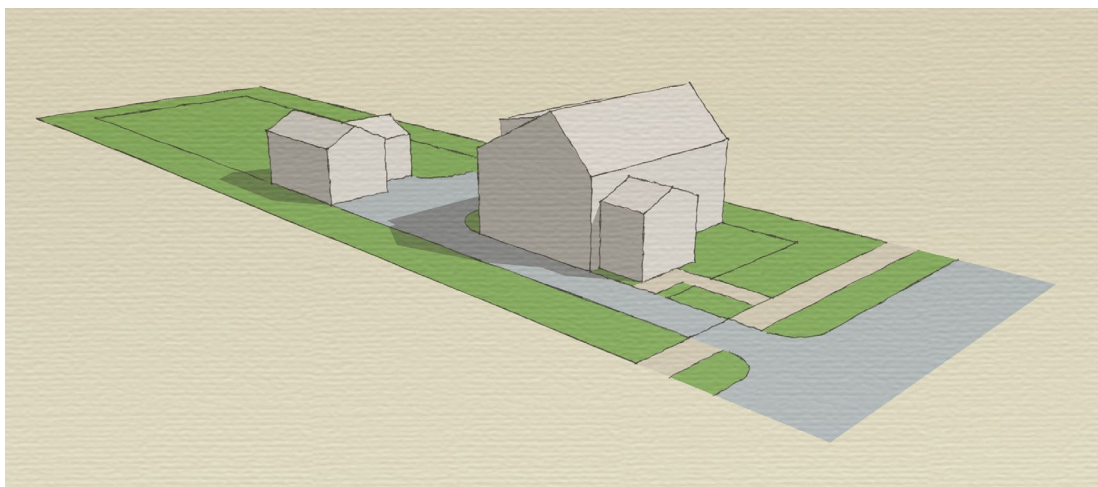

2103.C PERMITTED USES

- | | | |
|--|---|---|
| <p>Residential and Lodging Uses</p> <ul style="list-style-type: none"> (1) Single-family dwelling (2) Two-family dwelling (3) Multi-family dwelling ^{SP} (4) Rooming & boarding house ^{SP} (5) Accessory dwelling (6) Home occupation (7) Family childcare home (8) Bed and breakfast (9) Short-term rental (10) Group home (11) Care home ^{SP} | <p>Art and Entertainment Uses</p> <ul style="list-style-type: none"> (12) Public outdoor recreation, park or nature preserve ^{SP} <p>Civic and Community Uses</p> <ul style="list-style-type: none"> (13) Religious institution ^{SP} (14) Cemetery ^{SP} | <p>Natural Resource Based Uses</p> <ul style="list-style-type: none"> (15) Farming or forestry (16) On-farm business ^{SP} |
|--|---|---|

Notes
^{SP} Site plan review required

2103.D CONDITIONAL USES

- | | | |
|---|---|---|
| <p>Residential and Lodging Uses</p> <ul style="list-style-type: none"> (1) Home business ^{SP} (2) Lodging facility, up to 24 guests ^{SP} <p>Commercial Uses</p> <ul style="list-style-type: none"> (3) Office, professional, business or financial service ^{1 SP} (4) Personal service ^{1 SP} | <p>Industrial Uses</p> <ul style="list-style-type: none"> (5) Media recording or broadcasting studio ^{SP} (6) Communications antenna ^{SP} <p>Art and Entertainment Uses</p> <ul style="list-style-type: none"> (7) Artist gallery or studio ^{1 SP} (8) Museum or library ^{SP} | <p>Civic and Community Uses</p> <ul style="list-style-type: none"> (9) Government facility ^{SP} (10) Educational institution ^{SP} (11) Clinic or outpatient care service ^{1 SP} (12) Child day care ^{SP} (13) Funeral service ^{SP} (14) Social club ^{SP} |
|---|---|---|

Notes
¹ Limited to a maximum of 3,000 square feet
^{SP} Site plan review required